

GSM 908 User Guide

GB



DESIGN
AWARD
WINNER
1 9 9 8



INDUSTRIE FORUM
DESIGN HANNOVER

BOSCH



For your safety

Please pay special attention to the following simple guidelines. Breaking the rules may be dangerous or illegal.



In-car safety

Do not use your mobile phone when driving a vehicle except from in emergency cases. Always park the vehicle and take the ignition before using the phone.



Interference with other electronics

Mobile phones may interfere with other nearby electronics if these are not sufficiently protected from radio signals. Do not use your mobile phone near telephones, televisions, radios, personal computers, etc.



Risk of explosion

Don't use your mobile phone at petrol stations, fuel depots, chemical plants, etc. Always switch off your telephone before entering such areas, and observe any restrictions, regulations and rules.



Aircraft safety

The use of mobile telephones in an aircraft may be dangerous to the operation of the aircraft and is illegal. Switch off your mobile phone before boarding an aircraft. Before using your mobile phone near an aircraft, consult the crew.



Blasting

Don't use your mobile phone where blasting is in progress. Observe any restrictions, regulations and rules.



Medical electronics

Mobile telephones may interfere with the functionality of inadequately protected medical devices. Consult your physician or the manufacturer of the medical device if in doubt. Always switch off your mobile phone before visiting a hospital and observe the local regulations and rules.



Radiation

As with other mobile radio transmitting equipment, users are advised that for satisfactory operation of the equipment and for the safety of personnel, it is recommended that no part of the human body should be allowed to come too close to the antenna during operation of the equipment.



Children

A mobile telephone is not a toy. Keep the phone in a safe place out of children's reach. Children may harm themselves or others and they may damage the phone.



Electrical safety

This mobile telephone is intended for use when supplied with power from MA 1000, MA 1001, MA 1002, or MA 1003 chargers. The use of any other battery charging equipment will invalidate any approval given to this apparatus as well as the manufacturer's warranty.



Batteries

Batteries may explode if incinerated. To prevent any injury or burn please observe that the battery terminals never get in contact with conducting objects or are short circuited.

SIM card limitations

Network operators offer different kinds of services and different kinds of SIM cards. Please contact your network operator for further details.

Depending on your type of SIM card some features described in this user guide may not be available to you or may not be operated in the way described. Where a feature relates to the network you will see this symbol  in the user guide.

The memory capacity of your SIM card may differ from one type of card to another.

Batteries

Never dispose of old batteries in your household refuse. Return them to the place of purchase or take them to a recycling centre so that they may be disposed of in an environmentally friendly manner.

Accessories

The use of other types of chargers, batteries or any accessories other than those recommended for use with this telephone will invalidate any approval given to this apparatus as well as the manufacturer's warranty on the telephone.

Care of your phone

Do not try to open the phone as this might damage vital parts. The phone contains no components which can be repaired by the user. Any repair requires expertise and should be carried out only by an authorized service centre.

To clean your phone, wipe over with a soft cloth. Do not use alcohol or other solvents as these will harm your phone.

Do not use your mobile phone in high humidity environments or where the temperature falls below -10° or exceeds $+55^{\circ}$ C.

Precautions	Page 3	Tones setup	Page 31
Important notice	Page 4	Phone setup	Page 32
Keypad functions	Page 6	Message setup	Page 34
Display symbols	Page 7	Phone book setup	Page 35
Before you start	Page 8	Call timers and charge	Page 35
Making your first call	Page 10	Security	Page 36
Options when in conversation	Page 12	Calculator	Page 38
Phone book	Page 14	Accessories	Page 39
Phone book editing	Page 15	Index	Page 44
Alternative phone books ...	Page 17		
List menu system	Page 18		
Outgoing calls	Page 19		
Answered calls	Page 19		
Missed calls	Page 20		
Messages	Page 21		
Setup menu system	Page 24		
Call divert	Page 26		
Call barring	Page 28		
Call waiting	Page 29		
Supplementary network services	Page 30		

KEYPAD FUNCTIONS

LED (Status indicator)

Slow green flash: Your phone is in contact with a network.

Fast green flash: Indicates an incoming call.

Slow red flash: Your phone cannot get in contact with a network.

Fast red flash: The battery needs recharging.

⊙ On/off key

Press the key for one second to switch your telephone on or off.



Function keys with text line in display

The function of each key varies according to whether you are in standby, menu or conversation mode. The text line at the bottom of the display will inform you of the actual function of each key at any time.

⬆️ Arrow keys

In standby mode: Scroll through menus, phone book, lists, messages etc.

In conversation mode: Volume up/down.

📎 Side key

Same function as the arrow keys.

📧 Voice mail key

Quick access to your voice mail.

*+ Key

Inserts the "+" before international phone numbers.

0→→ Last outgoing call

Press for one second and the call is initiated automatically.



P Key

Inserts a pause between the main number and the extension number.

Introduction

Making a call

Enter phone number. Press **CALL**

Answering a call

The telephone rings. Press **ANSWER**

Ending a call

Press **END**

Back to standby mode

Press **EXIT**

The telephone automatically returns to standby mode when no key has been pressed for 60 seconds.



Battery level indicator

See page 8 for more information.



Signal strength indicator

The stronger the signal (more signal bars displayed), the better the radio connection.



List menu indicator



Phone book indicator

Scroll indicators



Shows you that there are more functions up or down which you can access. Also used for scrolling through the list menus.



Indicates which key to press to increase and decrease the volume level.



Speech call indicator



Fax call indicator



Data call indicator

SMS message indicators



There is a new message for you.



On: There are still unread messages.
Flashing: The SMS memory is full.



Voice mail indicator

Indicates that there is a voice mail for you.



Call divert indicator

On: All calls to your mobile telephone are diverted to another telephone number.

Flashing: Check the status of your call diverts.



Microphone off indicator



Volume level indicator

Indicates volume level when adjusting.



Ring volume off indicator



All-tones-off indicator

See page 31 for more information.



Calculator

Survey of arithmetic operations in the calculator menu.

Display and keypad backlighting

The backlight switches on automatically when you press a key. In standby mode the light will automatically switch off if no key is pressed for 10 seconds or more.

BEFORE YOU START

Insert rechargeable battery

When changing the battery your phone should always be switched off.

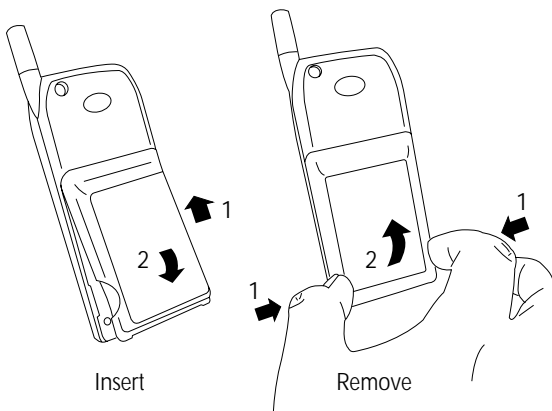

Charge the battery

The battery supplied with this telephone is completely discharged. The telephone will initiate charging as soon as you have inserted the charger plug. The battery takes 1 to 5 hours to become fully charged depending on type and size of the battery.

To obtain optimum battery performance in daily use, wait until the battery is completely discharged, before recharging to full capacity.

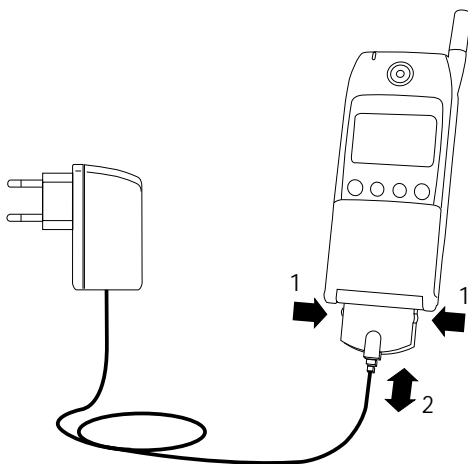

Battery level indicator

During charging the battery symbols will flash on and off one after another continuously from the bottom of the display up. When the battery is fully charged all 4 symbols are permanently displayed as long as the phone is switched on.

- 4 batteries: Battery is fully charged.
- 1- 3 batteries: Battery is partly discharged.
- 0 batteries: Battery needs recharging. You have limited conversation time left. At the same time the phone will emit a short warning tone and the LED on top of the phone will emit a fast red flash.

If you insert another battery, this should be fully charged in order to read out the battery capacity accurately.

Insert SIM card

Before you can make a call on your mobile phone you have to insert the SIM card.

Should you have forgotten to insert the SIM card the telephone will ask you to do so.

Before inserting the SIM card into the phone please make sure that any plastic remains from the frame punching have been removed.

Switch off your phone and remove the battery if attached on the phone.

1. Open the SIM card holder by sliding the catch to the left.
2. Lift the holder.
3. Insert the SIM card with its cut corner pointing up and left.
4. Close the holder and slide the catch back into place.
5. Insert the battery.
6. Switch on the telephone.

The phone will display a welcome greeting.

7. Enter PIN code, if requested, and confirm by pressing **OK**

The telephone will now start searching for your home network. When connection is successfully established, the name of your network operator will be displayed.

If the telephone cannot get in touch with your home network it will start searching for another co-operating network.

If the phone cannot establish contact with any network at all and you attempt to make a call, the display will show **please redial later**.

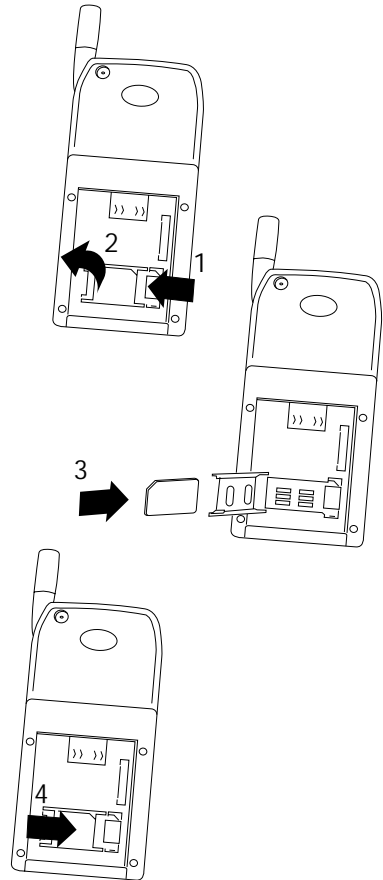

Selection of language

The display language of your phone is normally the national language of the country in which you purchased your SIM card. If this is not the case the display language will be English. You have the option of choosing between different languages.

⚠ If by mistake you select a language which you don't understand you can return to your own language by pressing the following keys:

* # 0000 # .

1. Press **MENU**
2. Press 31
3. Select language using ▼
4. Confirm by pressing **OK**
5. Press **EXIT**

Making your first call

1. Enter the phone number you want to call.
2. Press **CALL** to make the call.
3. Press **END** to end the call.

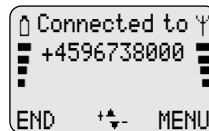
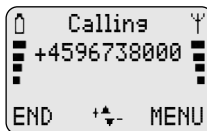

If you call a phone number which is diverted to another phone number, the display will show the phone number to which you are connected and not the one entered by you.

International calls

When making an international call, enter "+" by pressing the * -key for one second and then enter the relevant national code number before the telephone number (e.g. +45 for Denmark).

Phone numbers with extension number

Extension numbers can be dialled by entering a pause between the main number and the extension number. To enter a pause, press the **#**-key for one second until the pause code **P** appears on the display.

Emergency calls

In most cases emergency calls can be made with or without a SIM card. To make an emergency call without a SIM card just enter the worldwide mobile phone emergency number 112, press **SOS** and confirm by pressing **CALL**.

Answering a call

1. Press **ANSWER** when the phone rings.
2. Press **END** to end the call.

Use the arrow keys **▲** and **▼** to increase and decrease the speaker volume.

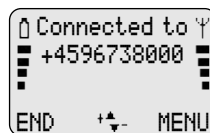

Muting the microphone

While having a call, you may wish to have a private conversation with someone else. You will hear everything your caller says but you cannot be heard by the caller.

To switch off the microphone:

1. Press **MENU**
2. Select **Microphone off**

To return to your telephone conversation:

1. Press **MENU**
2. Select **Microphone on**

Your telephone supports the following network options: Having more than one conversation at a time, placing calls on hold, switching between calls, joining calls and transferring a conversation to another phone number.

How to proceed

1. Press **MENU** when in conversation.
2. Select using ▼ either

Microphone off
Hold call
Continue call
Switch calls
Drop active
Join calls
Private
Drop held
Transfer call
Phone book
Send message

3. Confirm by pressing **OK**

Note: The status of the call determines which menu items are visible and available for you to select.

Putting a call on hold

You can make a second call without having to end a call that is currently active. Key in the second phone number and press **CALL**.

The first call will automatically be put on hold. Please be aware that you can only have one call on hold at a time. You can also put calls on hold manually by selecting **Hold call**.

Continuing a call

When you want to retrieve the call put on hold, just select **Continue call**.

Switching between calls

⤴ If you select **Switch calls**, the active call will be put on hold and the call on hold will now be active. In this way you can switch between your conversations.

Ending an active call while another is on hold

⤴ An active call can be ended by selecting **Drop active**. The held call will remain on hold and you have to retrieve it to continue conversation.

Joining calls

⤴ If you have an active call and a call on hold at the same time, you can select **Join calls** to enable all of you to speak together.

Having a private call while others are on hold

⤴ If you have joined all calls and want to have a private conversation with one of the callers, select **Private**. The other calls will be put on hold.

Ending a call put on hold

⤴ You can end the call put on hold by selecting **Drop held**.

Transferring a call

⤴ If you have an active call and a call on hold you can transfer the call without breaking the connection by selecting **Transfer call** so that the other parties can continue speaking to each other.

Calling a number in the phone book

⤴ During a conversation you can make a new call to a number stored in your phone book by selecting **Phone book**.

Sending an SMS message

If you want to send a message to a third party select **Send message**.

How to lock the keypad

To avoid making calls accidentally you can lock the keypad.

1. Press **MENU**
2. Press **#**

If you try to activate one of the keys, the display will tell you that the keypad is locked.

How to unlock the keypad

The keypad lock is automatically disabled

- during an incoming call until you have finished your conversation
- when the telephone is placed in the hands-free car installation kit

1. Press **UNLOCK**
2. Press **#**

You can store names and telephone numbers in a phone book. The entries are stored on the SIM card and the number of entries is dependent on the capacity of the SIM card.

The length of a name or a telephone number depends on your SIM card.

There are several characters available on each key, as shown in the table below. Press once to get the first character, twice to get the second character, and so on. When you need a space between two characters, press **#**

Holding down one of the keys for one second will give you the option of lower case. Just press the key again for one second to return to upper case.

1 1 2 3 4 5 6 7 8 9 0 * #	7 P Q R S 7 B Π Φ Ψ Σ p q r s 7 β
2 A B C 2 Æ Å Ä Ç a b c 2 æ å ä ç	8 T U V 8 Ü Ø t u v 8 ü ø
3 D E F 3 É Δ d e f 3 é è	9 W X Y Z 9 Æ w x y z 9
4 G H I 4 Γ g h i 4 ï	* + * +
5 J K L 5 Λ j k l 5	0 → 0 - / () = < > _
6 M N O 6 Ø M Ñ Ó Ω m n o 6 ø ñ ö ò	# P Space #

How to edit a name and a phone number

Press **CLEAR** briefly

– one character will be deleted

Press **CLEAR** for one second

– the entire display will be deleted

How to store a name and a telephone number

If you enter the phone number with the help of "+" followed by the national code you can use your phone book abroad without having to think about international codes.

1. Enter the phone number.
2. Press ▼
3. Enter name and press **OK**

The telephone will suggest that the name/number should be stored under the first vacant location number.

4. Confirm the location number by pressing **OK**

How to select your own location number

If you do not want to store the entry under the suggested location number, you can select a number of your own choice. Store frequently used numbers in location numbers 1 to 9 so that you can speed dial them by pressing only one key (see page 15).

1. Store telephone number and name as described previously in steps 1. to 3.
2. Press **CLEAR** and enter a location number of your own choice (up to 3 digits).
3. Confirm by pressing **OK**

If you choose a location number that is occupied, the phone will give you the option of overwriting the existing entry. If you do not want to overwrite the existing entry, press **EXIT** and the location number suggested will be visible again.

Voice mail number

If you have a voice mail number stored in your phone book this should be stored under location 1. On some networks this has already been done by the operator. Contact your network operator for further details on how to activate your voice mail.

How to find a name and a telephone number

1. Press **▼**
2. Enter one or more letters of the name you wish to find.
3. The name and telephone number will be displayed.

If there is more than one name matching the entered letters, use the arrow keys to scroll through to find the required name.

If there is no name to match the entered letters, the display gives you the best match in the phone book.

4. Press **CALL** to make the call.

When making a call the name will be shown on the display. If the entry has no name the telephone number will be displayed.

Speed dialling

It is possible to make calls to any number stored in the phone book more easily by using the location number (up to 3 digits).

To be able to use the speed dialling function it must be switched on (see page 32).

1. Press the location number for one second.

If the location number consists of more than 1 digit, press the first digit(s) and hold the last digit for one second.

2. The call will automatically be initiated.

How to edit a name or a telephone number

1. Press **▲** to enter the List menu system.
2. Select **Phone book** and press **SELECT**
3. Select **Edit entry** and press **OK**
4. Enter one or more letters of the entry you wish to edit or select it by using **▼**
5. Press **EDIT**
6. Change the number using **CLEAR**
7. Enter the correct phone number.
8. Confirm the change by pressing **OK**
9. Change name and location number in the same way, if necessary.

How to delete a name and a telephone number

1. Press **▲** to enter the List menu system.
2. Select **Phone book** and press **SELECT**
3. Select **Delete entry** and press **OK**
4. Enter one or more letters of the entry you wish to delete or select it by using **▼**
5. Press **DELETE**
6. Reconfirm by pressing **OK**

PHONE BOOK STATUS / PREFIX TELEPHONE NUMBERS

How to see the status of your phone book

The telephone can display the total number of locations on your SIM card and inform you how many of these are free.

1. Press ▲ to enter the List menu system.
2. Select **Phone book** and press **SELECT**
3. Select **Status** and press **OK**

Prefix telephone numbers

In your phone book you can store prefix phone numbers and add additional digits to these. A useful feature if for instance you often call a company with a switchboard with direct dialling facility.

How to enter a prefix telephone number

1. Enter the prefix digits of the telephone number.
2. Hold down the # -key for approx. 2 seconds, and you will see a W on the display.
3. Repeat, holding down the # -key for each character you wish to add to the prefix number.
4. Press ▼
5. Enter name and location number and press **OK**

How to call a prefix telephone number

1. Press ▼
2. Find the number you wish to call in your phone book.
3. Press **CALL**
4. Enter the actual digits to replace the W
5. The call will automatically be initiated.

Depending on your SIM card you may have different alternative phone books. These phone books will be visible in the phone display only if they are available and enabled.

Fixed numbers

 With the help of this alternative phone book you can restrict the use of your phone only to numbers stored in this special phone book. This telephone book operates in exactly the same way as your ordinary phone book.

However, in order to be able to make such a phone book you need to have a PUK2 code from your network operator and to use a PIN2 code of your own choice.

See on page 35 under Phone book setup how to make use of fixed numbers.

Service numbers

 This phone book contains customer care, hotline service numbers, etc. Your network operator defines the numbers stored in this phone book and the contents cannot be changed by you.

Barred numbers

 In this phone book you can store numbers to which you do not allow any calls. This phone book operates in exactly the same way as your ordinary phone book.

In order to be able to make such a phone book you also need to have a PUK2 code from your network operator and to use a PIN2 code of your own choice.

See page 35 under Phone Book Setup how to make use of barred numbers.

Own numbers

 Some networks offer the possibility of having more than one phone number on the same SIM card. For instance one for normal conversations, one for fax and one for data transmission.

This sub menu operates in the same way as the ordinary phone book menu giving you the possibilities of finding, adding, editing and deleting the entries.

LIST MENU SYSTEM

Information about outgoing, answered and missed calls as well as SMS messages are automatically stored in lists:

Outgoing calls

- View names/phone numbers of your latest outgoing calls

Answered calls

- View names/phone numbers of your latest answered calls

Missed calls

- View names/phone numbers of your latest calls received but not answered

Phone book

- Find, add, edit or delete entries
- Phone book status

Fixed number phone book



- Find, add, edit or delete entries
- Phone book status

Service number phone book



- Find entries

Barred number phone book



- Find, add, edit or delete entries
- Phone book status

Own numbers



- Find, add, edit or delete entries

Messages

- Inbox for received point-to-point messages
- Outbox for sent point-to-point messages
- Favourite messages
- Send messages
- Read broadcast messages

How to access the List menu system

1. Press ▲
2. Select the menu you want to access by using ▲ or ▼
3. Confirm by pressing **SELECT/OK**
4. Select the sub menu you want to access using ▼ and press **SELECT/OK**

Back to standby mode

While you are in menu mode, pressing **EXIT** briefly will bring you one level up in the system. Holding **EXIT** will always bring you to the standby mode.

The telephone automatically returns to standby mode when no key has been pressed for 60 seconds.

Outgoing calls

Your phone has memory for your last 10 dialled telephone numbers.

How to see the list of last outgoing calls

1. Press **▲** to enter the List menu system.
2. Select **Outgoing calls** and press **OK**.
3. Scroll through the telephone numbers.
4. When the telephone number you wish to redial is displayed, press **SELECT**.
5. Press **CALL** to initiate the call.

Shortcut to your last outgoing call

However, to use this facility you must enter the Phone setup menu and select **Speed dialling on** (see page 32).

1. Just press 0 for one second and the call is initiated automatically.

Who is calling?

Calling Line Identification (CLI) is a network feature whereby the phone numbers of callers to your phone are shown on your phone's display. If your caller is one of the entries that you have stored in your phone book, then his name will appear on your display.

To enable the telephone to identify the calls it is a condition that the network supports Calling Line Identification.

Answered calls

Your phone remembers the last 10 calls your phone has received.

How to see the list of answered calls

1. Press **▲** to enter the List menu system.
2. Select **Answered calls** and press **OK**.
3. Scroll through the telephone numbers.
4. When the telephone number you wish to redial is displayed, press **SELECT**.
5. Press **CALL** to initiate the call.

Missed calls

 Your phone remembers the last 10 incoming calls which you did not answer.

The display will tell you how many missed calls your phone has received. If, for instance, there are 15 missed calls the standby display will show  •15.

As the telephone registers only identified calls in the list, the number of missed calls shown on the display and the number of phone numbers actually listed may be different.

Immediate access to the list of missed calls

1. Press **▲**
2. Scroll through the telephone numbers using **▼** or **▲**
3. When the telephone number you wish to dial is displayed, press **SELECT**
4. Press **CALL** to initiate the call.

How to see the list of missed calls at a later moment

As soon as you have used the list, either to make a call or to view numbers, the  symbol will disappear from the display. However, the list will always be available through the List menu system.

1. Press **▲** to enter the List menu system.
2. Select **Missed calls** and press **OK**

The telephone number will be deleted from the list as soon as you have called it, but you can always find it again in the list of last outgoing calls.

How to copy a phone number from one of the lists into your phone book

1. Press **▲** to enter the List menu system.
2. Select the actual menu and the phone number you wish to copy into your phone book.
3. Confirm by pressing **SELECT**
4. Press **▼** to access your phone book.
5. Give the number a name and a location number and press **OK**

How to delete call information

You can delete all entries stored in the Outgoing, Answered and Missed calls lists. Select the sub menu **Delete call information** in the Phone book setup menu and select the list which you want to delete.

Short Message Services (SMS)

Your phone can receive and send short text messages via the network. On some networks you have to subscribe to this facility.

There are two types of messages: point-to-point messages which you can both receive and send, and cell broadcast messages which you can only receive.

Point-to-point messages

A new incoming message will be indicated by the SMS indicator  on the standby display, as well as by a message tone (if enabled – see page 31). The display will also inform you how many new messages there are for you.

How to read a new message

1. Press **▲** to access the messages.

The display will show date and time of receipt of each individual message.

2. Select the message you want to read by means of **▼** or **▲** and confirm by pressing **SELECT**

The phone number of the message sender will be displayed in front of the message. You can now scroll through the message by using the arrow keys.

The message is automatically stored in the inbox if you do not delete it.

In addition to reading the message, you can either

- delete it
- send a reply
- forward it to another phone number
- edit it before sending
- extract a phone number, if any, from the message to call or to store in your phone book
- call back to the sender

1. Press **OPTION**
2. Select the option you wish to enter and confirm by pressing **OK**
3. The display will guide you through the next steps.

When a message has been read it will be indicated by a **√** to the left of the date of receipt.

The SMS indicator  remains on the standby display as long as there are unread messages.

Delete messages

If the SMS indicator  is flashing, it indicates that the message memory is full.

You can delete all messages stored either in the Inbox or the Outbox at the same time.

1. Enter the sub menu **Delete messages**
2. Confirm by pressing **OK**

How to read a message again

1. Press **▲** to enter the List menu system.
2. Select **Messages** and press **SELECT**
3. Select **Inbox** by pressing **OK**
4. Scroll through the list of messages and confirm your choice by pressing **SELECT**

How to send a message

Before you can send a message you have to enter your network operator's telephone number for this special service. Contact your network operator to obtain this number. On page 34 you can see how you enter this special phone number and how to select validity period, transmission format etc. once for all. If you do not specify these parameters in the Setup menu system you will be asked for a specification each time you wish to send a message.

1. Press **▲** to enter the List menu system.
2. Select **Messages** and press **SELECT**
3. Select **New message** by pressing **OK**

Start entering your message using the keypad in the same way as you enter a name or a telephone number in the phone book. **▲** moves the cursor to the left, **▼** moves the cursor to the right. Delete unwanted characters by pressing **CLEAR**.

If you want to use the **#**-symbol in your SMS message press the **#**-key briefly twice.

4. End your message by pressing **OK**
5. Select whether you wish to **Send message** at once or whether you wish to **Save message** for sending it later on.
6. Confirm your choice by pressing **SELECT**

Having selected **Send message** the phone will ask for a phone number to send the message to. Either enter a phone number or select one from your phone book using **▼**

The message is automatically stored in Outbox under Messages in the List menu system.

Favourite messages

Your phone contains a list of frequently used messages, e.g.

The meeting .. is moved to ..

You only need to insert name, place or time in the empty spaces. You may also add or delete words, as required.

1. Press **▲** to enter the List menu system.
2. Select **Messages** and press **SELECT**
3. Select **Favourites** and press **OK**
4. Select the message you want to use and confirm by pressing **SELECT**

The cursor automatically points at the first empty space. Once you have filled this in, you can move the cursor to the next empty space simply by pressing **NEXT**. The cursor can also be moved forward and backward by pressing **▼** or **▲** respectively.

5. Complete the message by pressing **OK**
6. Send the message, or save it for later use.

How to edit an old message

1. Press **▲** to enter the List menu system.
2. Select **Messages** and press **SELECT**
3. Select **Inbox**, **Outbox** or **Favourites** by pressing **OK**
4. Select the message you wish to edit and confirm by pressing **SELECT**
5. Press **OPTION**
6. Select **Edit message** and press **OK**

A digit between the scroll indicators on the display indicates the number of the individual messages.

Cell broadcast messages

To select whether you want the cell broadcast option to be on or off you must enter the Message setup menu and select **Broadcast setup** (see page 34).

 These are general messages broadcast to a group of telephones and are available to network subscribers only. Cell broadcast messages are typically local weather and traffic reports, stock market prices, sports results etc. If you have selected Roaming, i.e. if you are abroad and connected to a foreign network (see page 28), you may be able to receive cell broadcast messages from other networks, too.

The messages are transmitted in numbered channels and in general each channel will contain information of the same type. Cell broadcast messages may be sent out in different languages. Contact your network operator for further details.

Cell broadcast channel list

To be able to receive cell broadcast messages you have to set up a list of the channels from which you want to receive information. See page 34 for how to set up this list and to specify what kind of information you wish to receive.

How to read a cell broadcast message

A cell broadcast message is scrolled twice on the display at the time of reception. If you don't see it at that time, you can read it via the List menu system by pressing **▲**, selecting **Messages** and then **Broadcasts**.

The display will show the Broadcast ID number and you can thus identify the kind of message received. Messages are read in exactly the same way as Point-to-point messages. A read message will be marked by **√**.

In addition to reading the message, you can either

- delete it
- store it on your SIM card
- forward it to another phone number
- extract a phone number, if any, from the message to call or to store in your phone book

1. Press **OPTION**
2. Select the option you wish to enter and confirm by pressing **OK**
3. The display will guide you through the next steps.

A cell broadcast message will be deleted when you switch off your telephone – even if the message has not been read.

The setup menu system offers you the possibility of setting the individual sub menus and options according to your own personal wishes.

Network services (Menu 1)

- 6-9 ▲ 11 Call divert
- 6-9 ▲ 12 Call barring
- 6-9 ▲ 13 Call waiting
- 6-9 ▲ 14 Closed user group
- 6-9 ▲ 15 Outgoing call identification

Tones setup (Menu 2)

- 21 Ring tone
- 22 Trembler (optional extra)
- 23 Message tone
- 24 Broadcast tone
- 25 Key tone
- 26 Factory settings

Phone setup (Menu 3)

- 6-9 ▲ 31 Selection of language
- 32 Dial setup
- 6-9 ▲ 33 Selection of network
- 34 Power saving function
- 35 Car kit options
- 36 Edit welcome greeting
- 37 Incoming call setup
- 38 Any key answer
- 39 Factory settings

Message setup (Menu 4)

- 41 Setup for sending Point-to-point messages
- 42 Setup for receiving Cell broadcast messages
- 43 Delete messages

Phone book setup (Menu 5)

- 51 Fixed dialling on/off
- 52 Barred dialling on/off
- 53 Phone book sorting
- 54 Delete all entries stored in the lists (Outgoing, Answered, Missed)



Call timers and charge (Menu 6)

- 61 View duration and cost of last call
- 62 View duration and cost of total calls
- 63 Reset call timers
- 64 Display call timer and cost during conversation
- 65 Call charge

Security (Menu 7)

- 71 PIN code
- 72 SIM card lock
- 73 Change network password
- 74 Encryption indication



Calculator (Menu 8)

Applications (Menu 9)

The availability of this menu depends on your SIM card. The options in this special menu are defined by your network operator. The menu allows you to set up a dialogue between you, your SIM card and your network operator.



How to access the Setup menu system

1. Press **MENU**
2. Select the menu you want to access using ▼
3. Confirm by pressing **SELECT**
4. Select the sub menu you want to access using ▼
5. Confirm by pressing **SELECT**

Back to standby mode

While you are in menu mode, holding **EXIT** will always bring you to the standby mode.

The telephone automatically returns to standby mode when no key has been pressed for 60 seconds.

Menu numbers

On the right hand side in the first line of the display you will always see the number of the menu and sub menu in which you are operating. This is indicated by up to 6 digits.

Example: **62**

6 = Menu 6: Call timers and charge

2 = Sub menu 2: View total calls

A √ before the sub menu/option number indicates the option you have selected.

Shortcut to the setup menu system

As you get more familiar with the Setup menu system, you will probably find it easier to access some of the menus simply by pressing the menu code number.

For example, to see the duration of your total calls:

1. Press **MENU**
2. Press **62**

CALL DIVERT

You have the option of diverting all calls or choosing to divert incoming calls only if unanswered. The unanswered calls option diverts calls

- if you are busy
- if you do not reply
- if there is no contact

Registration

 To enable a call divert you must register it first. You will be asked to specify whether you want the call divert function to apply to all services, speech, data services, fax services or message services (SMS).

Deactivation/activation

 You may not be able to make use of the deactivate and activate options. In that case you must cancel a call diversion by selecting **Cancel**. Next time you want your incoming calls diverted, select **Register**.

Calls can be diverted to a telephone number stored in your phone book or to any other number. Access your phone book by pressing **▼** or enter a phone number via the keypad.

If you have chosen to have all calls diverted, the call divert indicator **↔** will be visible on the standby display.

If you wish to suspend your calls being diverted for a time, select **Deactivate**. All registrations will remain in the network, so next time you wish to divert your calls to the same number, simply select **Activate**.

Validity time

If you have selected

Divert if unanswered

or

Divert if no reply

you can specify that a period of time must elapse before the call is diverted. This period can be from 5 to 30 seconds at intervals of 5 seconds.

It is always possible to see the status of the activated call diversions by selecting **Status**. Registered call diversions can be cancelled individually or can all be cancelled at once by selecting **Cancel all**.



How to activate call divert for all calls



1. Press **MENU**
2. Select **Network services** by pressing **SELECT**
3. Confirm by pressing **SELECT** once more to indicate that you want access to the call divert menu.
4. Select using ▼

```

Divert all calls
Register
- All services
- Speech
- Data services
- Fax services
- Message services
  - Number
Activate
Deactivate
Status
Cancel

Status
Cancel all (call diverts)
      
```
5. Confirm your choice by pressing **OK**

If you want to activate a call divert on the basis of

Divert if unanswered

Divert if busy

Divert if no reply

Divert if no contact

just follow the procedure described above giving you the same options.

CALL DIVERT

You can set up call barring for different types of outgoing and incoming calls to restrict the use of your phone.

You have to activate the type of call barring you wish to set up. You are asked to specify whether you want the call barring to apply for all services, speech, data services, fax services or message services (SMS).

When setting up or cancelling any call barring, you will be asked to enter your 4-digit password provided by your network operator.

You can always see the status of the actually activated call barring by selecting **Status**.

Outgoing call barring

Select **All calls** if you want to bar all outgoing calls. Select **International** if you want to bar international calls only. Select **Roaming** if you want outgoing calls to be barred when you are connected to a foreign network – this still leaves you the possibility of making calls to your home country.

Calls to Emergency Services (see page 11) can still be made even if all outgoing calls are barred.

1. Press **MENU**
2. Select **Network services** by pressing **SELECT**
3. Select **Call barring** using ▼ and confirm by pressing **SELECT**
4. Select using ▼

Outgoing calls

All calls

Activate

- **All services**

- **Speech**

- **Data services**

- **Fax services**

- **Message services**

Status

Cancel

Status

Cancel all (call barrings)

5. Confirm your choice by pressing **OK**

If you want to activate call barring for

International calls

Roaming calls

just follow the procedure described above giving you the same options.

Call barring of incoming calls is activated and cancelled in exactly the same way covering the sub menus

All calls

Roaming calls

Incoming call barring

Select **All calls** if you want to bar all incoming calls. Select **Roaming** if you want incoming calls to be barred only when you are connected to a foreign network.

Cancelling call barrings

Call barrings can be cancelled individually or by selecting **Cancel all**.

Call waiting

During a conversation your telephone can notify you that a new call is waiting. This is indicated by a special ringing tone in the earphone. To activate this function just select **Activate** in the Call waiting option.

If you want to answer the new call press **ANSWER**. The active call will be put on hold automatically.

See page 12 for further details on how to handle multi-party calls.

If you do not want to answer the call, press **REJECT** instead. You can have the new call diverted to, for example, your telephone answering service. See page 26 for how to set up a call divert.

If you do not want to be disturbed by new incoming calls you can disable the function by selecting **Cancel** in the Call waiting option.

You can always see whether Call waiting is activated or not by selecting **Status**.

SUPPLEMENTARY NETWORK SERVICES

Closed user group

⤴ This is a network feature by which the use of your telephone is restricted to certain phone numbers within a group defined by the network operator and the owner of the SIM card. You may be a member of different groups. Each group has its own ID number. The network defines which group is your default user group. You have the option of calling outside the group – perhaps at a higher charge.

Outgoing call identification

⤴ You can select whether you want your phone number to be shown or not at the next outgoing call. In Network Service select the option **Outgoing call identification**, then **Show info for next call** and confirm your choice by pressing **OK**.

Unstructured supplementary services (USSD)

On some networks you have the possibility of sending unstructured supplementary service strings. An USSD service string should always be terminated by pressing the **#**-key.

In order to be able to send USSD service strings you must enter the Phone setup menu and select **Speed dialling off**. Pressing the relevant keys 0 to 9 for one second will lead you to the alpha mode enabling you to enter letters and digits instead of only digits.

Contact your network operator for further information on these supplementary services.

How to adjust tones

1. Press **MENU**
2. Select **Tones setup** using ▼
3. Confirm by pressing **SELECT**
4. Select using ▼ either
 - Ringing tone**
 - Trembler** (Optional extra)
 - Message tone**
 - Broadcast tone**
 - Key tone**
 - Factory settings**
5. Confirm by pressing **SELECT**
6. Select the volume or pattern you want to change using ▼
7. Confirm by pressing **OK**

Ringing volume level and ringing tones

You can adjust the ringing volume level and select the ringing tones according to your surroundings and preferences.

Ringing volume levels are high, medium, low, escalating and off. The LED on top of the phone will emit a fast green flash to indicate an incoming call. If the ringing tone is set to **off** you will see the 🎵 symbol on the standby display.

You have the option of selecting between 27 different ringing tone patterns.

The selected ringing tone will sound at the relevant ringing volume level when making your selection.

You can disable all kinds of tones by pressing **MENU** and then *****. In that case the symbol 🎵 will be seen in the display. Just press **MENU** and ***** again to revert to your original settings.

Trembler

If you have a trembler battery you can select whether the trembler should be active or not at an incoming call.

Message tone

Your telephone can alert you to the arrival of a SMS message by means of different alert tones.

Keypad tone

To help you keep check on your dialling, the phone can be set to give 8 different tone patterns following every key pressed.

Factory settings

You can always return to the original tones setup of your phone. The phone is set up by the manufacturer as follows:

Ringing volume level:	Loud
Ringing tone:	British
Trembler:	Off
Message tone:	Simple
Broadcast tone:	Discreet 1
Key tone:	3

This menu offers you the possibility of setting some of the telephone's options according to your own personal wishes.

How to set up options

1. Press **MENU**
2. Select **Phone setup** using ▼
3. Confirm by pressing **SELECT**
4. Select using ▼ either
 - Language
 - Dial setup
 - Network selection
 - Power saving
 - Car kit
 - Greetings
 - Incoming call setup
 - Any key answer
 - Factory settings
5. Confirm by pressing **SELECT**
6. Make your selection using ▼
7. Confirm by pressing **OK**

Language selection

 The display language of your phone is normally the national language of the country in which you purchased your SIM card. If this is not the case the display language will be English. You have the option of choosing between different languages. (See page 10 for how to select language).

Dial setup

Automatic redial

If the phone number you are calling is busy or your call is not answered, you can let your phone make up to 10 automatic redial attempts. A special redialling success tone sounds when the attempt is successful. To cancel the auto redialling attempts just press the left function key.

Speed dialling

To speed dial using your location numbers, you have to select **Speed dialling on**. If you do not want to make use of this feature, select **Speed dialling off**.

Network selection

 When you wish to use your phone abroad, you have to select a foreign network. This can be done either manually or by letting your telephone do it for you automatically.

In the automatic mode, your phone will automatically try to reach your home network first, then, alternatively to find another available network stored in a preferred list made by you (see below).

In the manual mode, the phone will always start searching for the network with which it was in contact when it was switched off. If the phone cannot locate this network it will present some alternative networks on the display, and you can then select one manually.

You can select any network from the list, but your phone can get in contact only with co-operating networks (Roaming). The telephone can get into contact with other networks but only for emergency calls.

Your dealer or network operator can tell you which networks are co-operating.

Preferred list

The list of networks on your SIM card defines the order of preference in which your phone will select a network in automatic mode. Network operators offer different services and call charges; therefore it may be beneficial for you to make a preferred list of your own. Enter the individual networks in your own order of preference and store them on your SIM card.

To do this, you must access the Selection of network sub menu, select the Set preferred list option and use ▼ to select the empty location in which you want to store the new network. Pressing **EDIT** will give you a list of available networks. Scroll through the list using ▼. When you see a network you wish to store in your preferred list, just press **OK**. If you select a currently used location and press **EDIT**, the former occupant can be deleted when you enter the new one. Just press **EXIT** to leave the list as it was.

Once a network is stored in the preferred list, you can always see the country and network code of the actual network by pressing **EDIT** in the Set preferred list option.

Power saving

To save your battery and thus increase both conversation and standby times you can select whether you want the display contents to be visible or not in standby mode.

Select **Display remains on** if you want it to be visible, and **Display switches off** if you want it not to be visible. The display will switch off after 3 minutes in standby mode.

In standby mode the display and keypad backlight will always switch off after 10 seconds if your telephone is set to **Backlight on**. However, you have the option of having the backlight switched off permanently by selecting **Backlight off**.

Car kit installation

This option is only effective if the phone is connected to a handsfree car kit. See page 39 for more information.

Welcome greeting

You can change the welcome greeting of your phone according to your own wishes. Delete the old message by holding **CLEAR**, enter the new greeting via the keypad and confirm by pressing **OK**.

Incoming call setup (fax/data)

Do not enter this menu unless you are using your phone for fax and data communications! Fax and data capability will require a separate data interface kit (optional). The menu settings are explained in the user guide supplied with this kit.

Any key answer

You can answer an incoming call by pressing any key you like except for the left function key and the arrow keys if you select **Any key answer on**.

Factory settings

You can always return to the original setup of your phone. The phone is set up by the manufacturer as follows:

Language:	Automatic
Dial setup:	Autoredial off Speed dialling on
Network:	Automatic
Power saving:	Display on Backlight on
Car kit:	Auto answer off Auto power off automatic
Greeting:	Welcome
Incoming call setup:	Next call type: Speech All call type: Speech
Any key answer:	Off

Send message setup

Before you can send a message you have to enter your network operator's telephone number for this special service. Contact your network operator to obtain this number.

1. Press **MENU**
2. Select **Message setup** using ▼ and confirm by pressing **SELECT**
3. Select **Send message setup**
4. Select **Service centre**
5. Confirm by pressing **SELECT**
6. Enter the SMS operator telephone number. Remember to add "+" and national code before the number.
7. Press **OK**

The number will automatically be used for sending all future messages.

Having stored a service centre number you have the option of adding a new service centre, deleting a service centre or editing the number of an existing service centre by pressing ▼ and confirm your choice by pressing **OK**.

The option of storing more than one service centre number may not be available with all SIM cards.

If for some reason your message cannot be delivered, it will remain with your SMS operator for a period of time specified by you under Validity period.

Under the option Teleservice you can specify in what format you want your messages to be sent - for instance select **Text message** if you want to send it to another mobile telephone.

For messages that have to be sent via several service centres to reach the recipient, some networks offer the feature of sending a reply, if any,

back to you through the same chain of service centres. To keep this possibility open, you must enter the Send Message Setup option and select **Reply path on**.

Broadcast setup

To set up the list covering the kind of information you wish to receive, select the option **Broadcast channels**. The display will show you various locations in which you can store the individual channels. Pressing **EDIT** will give you a range of different kinds of information. Use ▼ to scroll through the possibilities and confirm your choice by pressing **SELECT**. The selected kind of information is now stored in the channel list. Proceed in the same way if you want to receive other kinds of information.

Some network operators offer cell broadcast messages in different languages. Select the option **Broadcast language** and confirm your choice by pressing **OK**.

You can select whether you want the cell broadcast option to be on or off by selecting **Broadcast settings** and using ▼ to select whether the function should be on or off.

PHONE BOOK SETUP / CALL TIMERS AND CHARGE

Fixed dialling

In order to enable you to make use of fixed dialling numbers stored in an alternative phone book defined by you, select **Fixed dialling on**. Having selected **Fixed dialling on** your ordinary phone book will not be visible on the display and can thus not be accessed, but, of course, it will remain on your SIM card and can be accessed again by selecting **Fixed dialling off**.

Barred dialling

If you have a barred dialling phone book on your SIM card you must select **Barred dialling on** to enable it. Having selected **Barred dialling on** any attempt to make a call will make the phone compare the dialled number with the numbers stored in this special phone book. If the dialled number is stored in the Barred numbers phone book the call will be refused.

To enable the fixed dialling and the barred dialling phone books you have to enter your PIN2 code.

Phone book sorting

You have the option of selecting whether you want your phone book sorted by name or by location.

Delete call information

You can delete all entries stored in the Outgoing, Answered and Missed calls lists. Select the sub menu **Delete call information** and select the list which you want to delete.

Call timers and charge

Your telephone can display the actual duration and cost of an ongoing conversation if you so wish. It can also show you the duration and cost of the last call and all calls made with your SIM card since the timer was last reset. However, the call charge feature must be supported by your network.

In order to be able to see the cost in the display you have to enter a unit price and the actual currency. You can also enter a maximum call charge limit, so that when this maximum has been reached no more phone calls can be made. The telephone will inform you about the remaining call charge balance.

To enter or change call charge and currency you will be requested to enter your PIN2 code.

How to see timers

1. Press **MENU**
2. Select **Call timers and charge** using ▼
3. Confirm by pressing **SELECT**
4. Select using ▼ either

```
Last call
Total calls
Reset timers
Display timer (on display)
Call charge
- maximum
- unit price
- currency
- remaining
```

5. Confirm by pressing **OK**

PIN code

To prevent misuse of your SIM card, e.g. if it is lost or stolen, you can select a PIN code to be entered each time you switch on the phone.

The PIN code is a 4 to 8-digit number of your own choice, which you can change any time you like.

If you enter an invalid PIN code three times, your SIM card will be blocked and to unblock it you have to enter the PIN Unlocking Key (PUK) code supplied by your network operator. This procedure prevents unauthorized person from working out your PIN code by repeatedly entering different combinations of numbers.

The display will inform you how many tries you have left before the SIM card is blocked. If you enter an invalid PUK code 10 times, your SIM card will be permanently blocked and you have to contact your network operator to have it unblocked.

Some SIM cards use a PIN2 code for accessing special functions. Contact your network operator for further information on PUK2 and PIN2 codes.

How to enable, disable and change PIN codes

1. Press **MENU**
2. Select **Security** using **▼**
3. Confirm by pressing **SELECT**
4. Select using **▼** either
 - PIN code**
 - PIN code on
 - PIN code off
 - PIN code change
 - Change PIN
 - Change PIN2
 - SIM lock**
 - SIM lock on
 - SIM lock off
 - Network password**
 - Encryption indication**
 - Encryption indication on
 - Encryption indication off
5. Confirm your choice by pressing **OK**

SIM lock

You can link your telephone and your SIM card together. This means that if, for instance, your phone is stolen it cannot be used together with another SIM card. To enable this feature just select **SIM lock on** and enter an 6 to 16-digit code of your own choice. *For your own sake remember to write down this code to be able to deactivate the lock at a later time. You have 10 attempts before the phone is blocked.* ^(*)

How to change password

If you subscribe to a call barring service your network operator will have supplied you with a 4-digit password. If you want to change this, select **Network Password** in the Security menu.

Encryption indication

 If you connect to a network which does not support encryption, you will get a warning in the display when trying to make a call. You have the option of turning off this network warning by selecting **Encryption indication off** in the security menu.

You can use your mobile phone as an ordinary calculator.

How to use the calculator

1. Press **MENU**
2. Select **Calculator** using **▲**
3. Confirm by pressing **OK**

Your telephone now acts as a normal calculator. The equal-sign (=) is found on the right hand function key.

Hold down the relevant key for one second to get the desired arithmetic operation.

By pressing **▲** you get access to a survey of what arithmetic operation is placed on what key.

Key	Operation
1	Addition (+)
2	Multiplication (*)
3	Square function (x^2)
4	Subtraction (-)
5	Division (/)
6	Square root ($\sqrt{\quad}$)
7	Percentage (%)
8	Fractions (1/x)
9	Exponent (E)
* *	M+ or decimal point (press briefly)
0	MC
#	MR or -/+ (neg./pos.) (press briefly)

Calculation examples

5 plus 2

Press 5, hold down 1 for one second, press 2 and press = **(7)**

8 divided by 4

Press 8, hold down 5 for one second, press 4 and press = **(2)**

Square root of 8

Press 8 and hold down 6 for one second **(2.8284271)**

15 per cent of 60

Press 6, 0, hold down 2 for one second, press 1, 5, hold down 7 for one second **(9)**

-5.2 times 10,000

Press 5, *****, 2, **#**, hold down 2 for one second, press 1, hold down 9 for one second, press 4 and finally = **(-52000)**

As soon as a figure is stored in the memory this will be indicated on the display by an **M**. You can access the memory by pressing **▼** or the **#**-key (MR).

The memory is reset each time you switch off your phone.

Professional Handsfree Car Kit

Remove the rubber plug covering the antenna hole on the back of the handset.

When placing the phone in the cradle, make sure that the antenna catch is open (slider in left hand side position). When the phone is in place, move the slider to the right hand side for locked position.

When your phone is placed in the cradle, it will switch on automatically with the car ignition. You can select whether you want the telephone to switch off automatically with the car ignition after a delay of 1 hour or whether you want to switch it off manually.

If you have selected **Switch off automatically** and want to switch your telephone off while the ignition is still on, you must do so manually.

The display and keypad backlighting on your phone will switch on and off automatically with the car ignition. While the phone is switched on and placed in the cradle the backlighting will remain on continuously.

The battery will be automatically recharged as necessary.

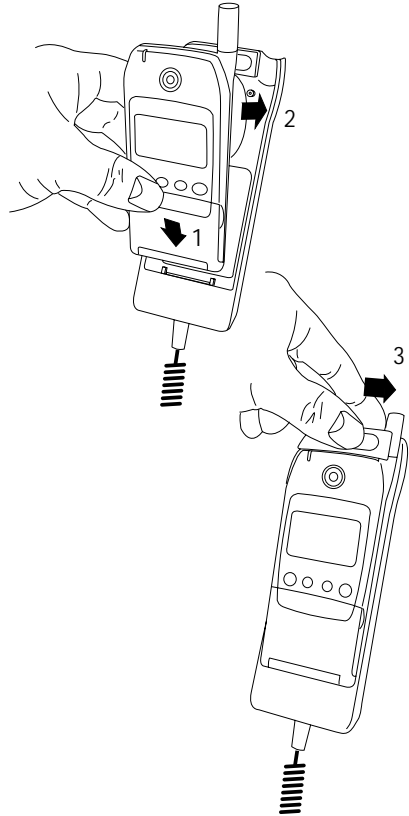

How to make a hands-free call

1. Enter the phone number you wish to call or retrieve it from the phone book.
2. Press **CALL** to let the conversation take place via the external speaker and microphone.
3. Press **END** to end your call.

How to receive a hands-free call

1. Press **ANSWER** when the phone rings.
2. Press **END** to end your call.

By selecting **Car kit auto answer on** you can set your telephone to answer a call automatically after 5 seconds. This option is only effective when the car ignition is on.

If you have selected **Any key answer on** in the Phone setup menu you can, of course, answer the call by pressing any key.

If you want to switch from hands-free mode to normal mode, just lift the handset and cradle as one complete unit – and back again for returning to hands-free. The switching is performed automatically.

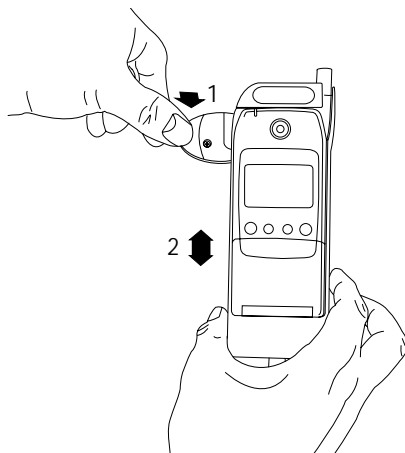

Basic Car Kit

Remove the rubber plug covering the antenna hole on the back of the handset.

When placing the phone in the cradle, make sure that the antenna catch is open (slider in left hand side position). When the phone is in place, move the slider to the right hand side for locked position.

The cradle connects to the car's cigar lighter plug and external antenna.

The battery will be automatically recharged as necessary.

When your phone is switched on and placed in the cradle, the backlighting will remain on.

An external antenna must be connected, since the handset antenna is disconnected when the phone is placed in the cradle.

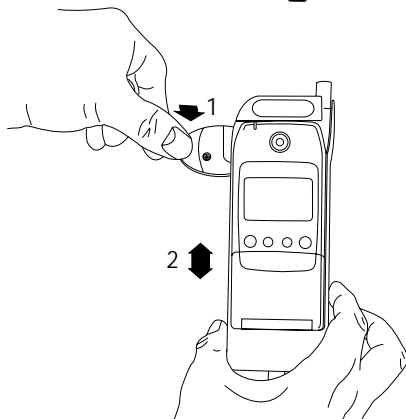
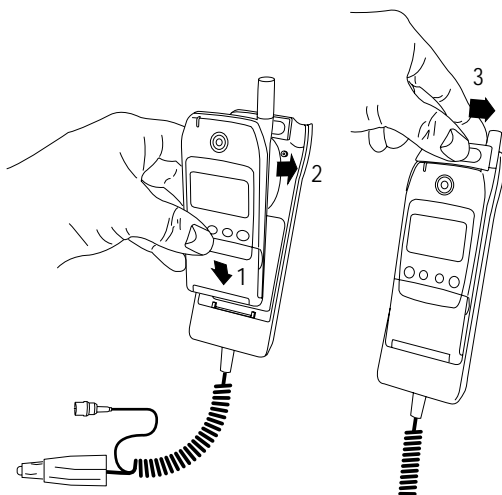

Simple Car Holder

Using the Simple Car Holder will require a special knob to be fitted on the back of your phone. The necessary parts come with the package.

How to fit the knob:

Remove the label from the back of the phone. The knob can now be fitted by means of a screwdriver. Place the new label to cover the screw.

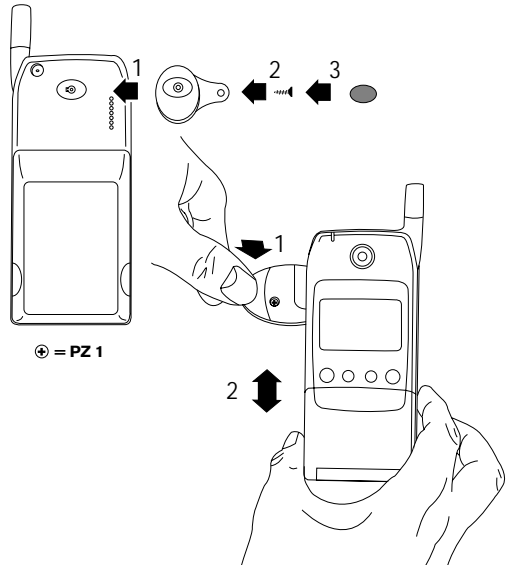

Headset

How to make a hands-free call

1. Enter the phone number you wish to call or retrieve it from the phone book.
2. Press **CALL** to let the conversation take place via the external speaker and microphone.
3. Press **END** to end your call.

How to receive a hands-free call

1. Press **ANSWER** when the phone rings.
2. Press **END** to end your call.

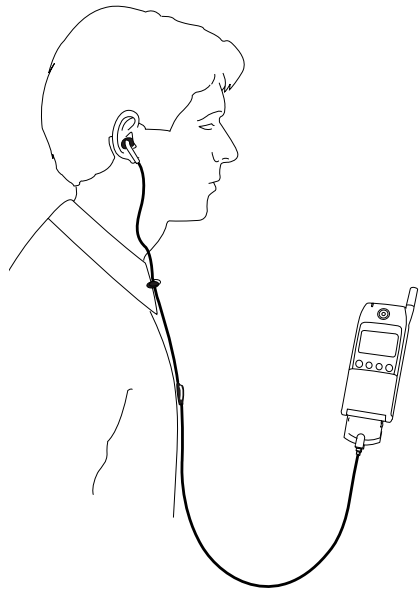

Desktop charger

The desktop charger is powered by means of the charger supplied with your telephone.

When you place the telephone in the desktop charger you have to make sure that the battery symbols on the display start flashing. The battery takes 1 to 5 hours to become fully charged depending on type and size of the battery. During charging the battery symbols on the display of your telephone will flash on and off one after another. When the battery is fully charged all 4 symbols are permanently displayed.

A spare battery can be attached for charging on the back of the desktop charger. The LED indicator on the front will show a red light during charging and a green light when the spare battery is fully charged. The indicator will be off when there is no spare battery attached.

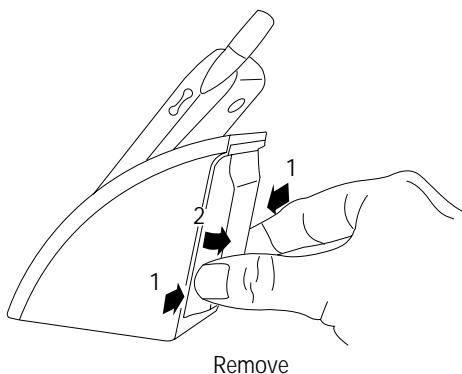
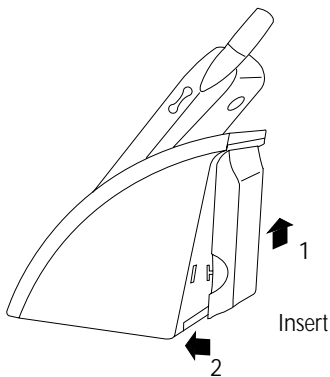
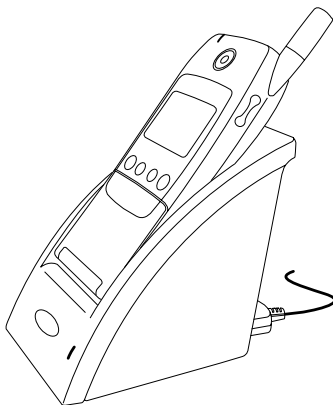

Belt clip

The necessary parts for fitting the belt clip to your phone comes with the package.

How to fit the belt clip:

Remove the label from the back of the phone. The belt clip can now be fitted by means of a screwdriver. Place the new label to cover the screw.

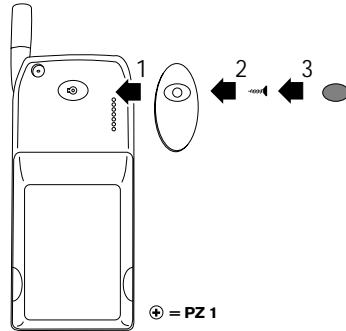

Data Interface

Your phone can be connected to your PC or laptop computer for data and fax communication. Please refer to separate user guide supplied with the kit.

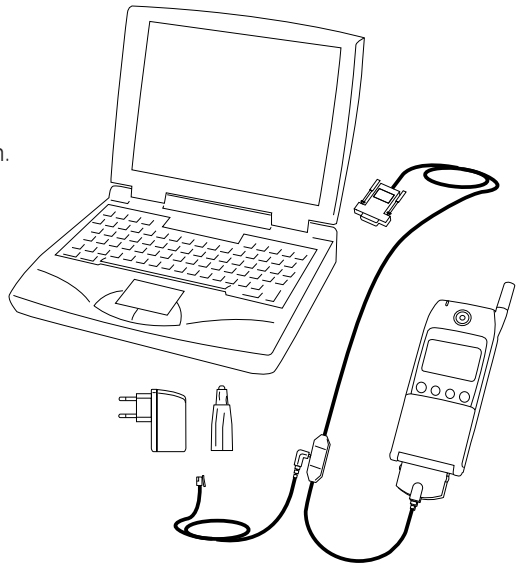

Other accessories

- Extra Light 350 mAh Li-ION battery
- Vibra-Alarm 650 mAh Li-ION battery
- Light 650 mAh Li-ION battery
- Light 750 mAh NiMH battery
- High Power 1800 mAh Li-ION battery
- Travel Charger
- Cigarlighter Charger 12/24 V

INDEX

Accessories	39	Find a name/number	15	Prefix telephone numbers	16
Alternative phone books	17	Fixed numbers	17	Private calls	13
Answered calls	19	Greeting	33	Professional handsfree	
Answering a call	7, 11	Headset	41	car kit	39
Any key answer	33	Important notice	4	PUK code	36
Auto answer	39	Incoming call setup	33	PUK2 code	36
Automatic redial	32	International calls	10	Putting a call on hold	12
Automatic switch off	39	Joining calls	13	Reading a message	
Barred numbers	17	Keypad	6	- cell broadcast	23
Basic car kit	40	Keypad lock	13	- point-to-point	21
Battery	8	Keypad tone	31	Remaining call charge	35
Battery level indicator	8	Language	10	Reset timers	35
Before sending messages	22	List menu system	18	Ringing tones	31
Before you start	8	Location numbers	14	Security	36
Belt clip	43	Making a call	7, 10	Selection of language	10
Broadcast channel list	34	Maximum call charge	35	Selection of network	32
Broadcast language	34	Menu numbers	25	Sending a new message	22
Broadcast setup	34	Messages		Service centre (SMS)	34
Calculator	38	- cell broadcast	23	Service numbers	17
Call barring	28	- favourites	22	Setup menu system	24
Call divert	26	- point-to-point	21	SIM card	9
Call timers/charge	35	Message setup		SIM card limitations	4
Call waiting	29	- cell broadcast	34	SIM lock	36
Car kit installation	39	- point-to-point	34	Simple car holder	41
CLI	19	Message tones	31	Speed dialling	15
Closed user group	30	Missed calls	20	Store a name/number	14
Continuing calls	12	Muting the microphone	12	Supplementary network	
Currency/Call charge	35	Network password	37	services	30
Data/fax transmission	33	Network selection	32	Switching calls	13
Data interface	43	Options in conversation	12	Tones setup	31
Delete all messages	21	Outgoing calls	19	Transferring calls	13
Delete a name/number	15	Outgoing call identity	30	Trembler	31
Delete call information	35	Own numbers	17	Unit price	35
Desktop charger	42	Phone book	14	USSD	30
Display	7	Phone book sorting	35	Voice mail	15
Duration of last call	35	Phone book status	16	Volume control	7
Duration of total calls	35	Phone setup	32	Welcome greeting	33
Edit an old message	23	PIN code	36		
Edit a name/number	15	PIN2 code	36		
Emergency calls	11	Power saving	33		
Encryption indication	37	Precautions	3		
Extension numbers	11	Preferred list	32		
Factory settings					
- telephone	33				
- tones	31				

BOSCH EASY SETS

Accessories for Bosch mobile phones



GSM 908



For the car

Professional Handsfree Car Kit



Basic Car Kit



Simple Car Holder



Cigarette lighter Charger 12V/24V



For the computer

Data Interface



For charging

Desktop Charger



Travel Charger - EU



Travel Charger - UK



Travel Charger - AUS



Travel Charger - US



For power

Extra Light 350 mAh Li-Ion battery



Light 650 mAh Li-Ion battery



Vibra-Alarm 650 mAh Li-Ion battery



Light 750 mAh NiMH battery



High Power 1800 mAh Li-Ion battery



Outfit

Headset



Belt clip



- D** Bosch Telecom GmbH
Produktbereich Endgeräte
Kleyerstr. 94,
60326 Frankfurt/Main,
Tel. (0 180) 5 22 14 92
Fax (0 180) 5 22 14 93
- B** N.V. Robert Bosch S.A.
Rue Henri Genessestraat 1,
10 70 Bruxelles / Brussel
Tel. (02) 5 25 5460
- DK** Robert Bosch A/S
Telegrafvej 1, 2750 Ballerup,
Tel. 44 89 89 89
- F** Robert Bosch (France) S.A.
B.P. 170, 32 Avenue Michelet,
93404 Saint Ouen,
Tel. (0) 1 40 10 70 07
- GR** Robert Bosch S.A.
162 Kifissou, 12131 Peristeri, Athens,
Tel. (30 1) 57 01 286
- NL** Robert Bosch BV
Neptunusstraat 71,
2132 JP Hoofddorp,
Tel. 023 56 56-3 91
- GB** Robert Bosch Ltd.
Sales Communication Equipment
P.O. Box 98
Uxbridge, Middlesex UB9 5HJ
Tel. 0345 585220
- I** Robert Bosch
Industriale e Commerciale S.P.A.
Via M.A. Colonna 35, 20149 Milano,
Tel. (3 92) 36 96-1
- N** Robert Bosch AS
Postboks 629, 1411 Kolbotn,
Tel. 66 81 70 00
- S** Robert Bosch Aktiebolag
Box 1154, 164 26 Kista,
Tel. (8) 7 50 15 00
- P** Robert Bosch Lda.
Av. Infante D. Henrique, Lotes 1E, 2E,
Apartado 8058, 1801 Lisboa Codex,
Tel. (35 11) 8 50 00 00
- E** Robert Bosch SA
Ctra. Nacional VI, km. 18,150,
28230 Las Rozas Madrid
Tel. (3 41) 6 31 23 72
- A** Robert Bosch AG
Postfach 146, 1110 Wien,
Tel. (4 31) 7 97 22-0
- CH** Robert Bosch AG
Industriestr. 31, 8112 Otelfingen,
Tel. (4 11) 8 47 14 14
- TR** Bosch Sanayi ve Ticaret A.S.
Ambariar CAD No. 4,
34780 Zeytinburnu-Istanbul
Tel. (0212) 5 58 24 70
- H** Robert Bosch Kft.
P.O. Box 331, 1475 Budapest
Tel. (3 61) 43 13 710
- SF** OY Hedengren AB
Lauttasaarentie 50,
00200 Helsinki
Tel. (90) 68 281
- IRL** Beaver Distribution Ltd.
Greenhills Road, Tallaght, Dublin 24,
Tel. (35 31) 4 51 52 11
- L** Central Import Export Corporation
Zone Industrielle, Rue des Jones,
1818 Howald,
Tel. (2) 40 30 60
- SGP** Robert Bosch Pte Ltd
38c Jalan Pemimpin,
Singapore 57180,
Tel. 3 50 54 52
- ZA** Robert Bosch (Pty) Ltd.
Private Bag X118, Randjespark,
Midrand 1685
Rep. of South Africa
Tel. (011) 651-9600

<http://www.bosch-telecom.de>

BOSCH

7910.2000 GB / 04.99

